

**SPECIAL APPLICATION JAW PLATES**  
特殊虎口

Unit:mm

平面虎口 (Hardened / 熱處理 HRC55°~58°)  
PJ-100S,130S,160S,200S,250S(不定寸規格)  
PJ-100V,130V,160V,200V,250V(定寸規格)(E= $\begin{smallmatrix} 0 \\ -0.02 \end{smallmatrix}$ )

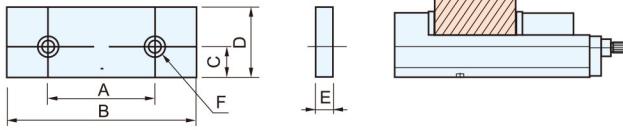

	07888002	07888006	07888010	07888014	07888018
PJ	100	130	160	200	250
A	60	90	90	120	160
B	100	130	160	200	250
C	22	25	25	28	35
D	48	55	58	63	80
E	15	15	15	18	21
F	M10x20L	M10x20L	M10x20L	M12x25L	M12x25L

刻齒虎口 (Hardened / 熱處理 HRC55°~58°)  
RJ-100S,130S,160S,200S,250S(不定寸規格)  
RJ-100V,130V,160V,200V,250V(定寸規格)(E= $\begin{smallmatrix} 0 \\ -0.02 \end{smallmatrix}$ )

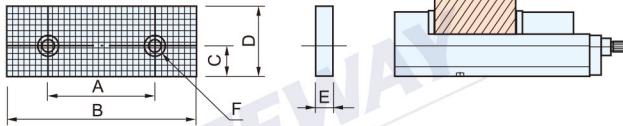

	07888022	07888026	07888030	07888034	07888038
RJ	100	130	160	200	250
A	60	90	90	120	160
B	100	130	160	200	250
C	22	25	25	28	35
D	48	55	58	63	80
E	15	15	15	18	21
F	M10x20L	M10x20L	M10x20L	M12x25L	M12x25L

加厚平面虎口 (Hardened / 熱處理 HRC55°~58°)  
PJ-1001,1301,1601,2001  
PJ-1002,1302,1602,2002

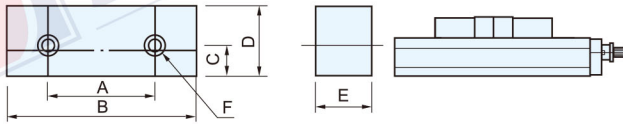

	07888132	07888136	07888140	07888144	07888148	07888152	07888156	07888160
PJ	1001	1301	1601	2001	1002	1302	1602	2002
A	60	90	90	120	60	90	90	120
B	100	130	160	200	100	130	160	200
C	22	25	25	28	22	25	25	28
D	48	55	58	63	63	73	73	102
E	48	48	48	63	48	48	48	63
F	M10x50L	M10x50L	M10x50L	M12x65L	M10x50L	M10x50L	M10x50L	M12x65L

加厚刻齒虎口 (Hardened / 熱處理 HRC55°~58°)  
RJ-1003,1303,1603,2003  
RJ-1004,1304,1604,2004

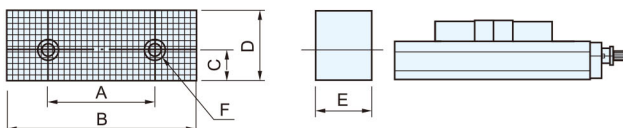

	07888164	07888168	07888172	07888176	07888180	07888184	07888188	07888192
RJ	1003	1303	1603	2003	1004	1304	1604	2004
A	60	90	90	120	60	90	90	120
B	100	130	160	200	100	130	160	200
C	22	25	25	28	22	25	25	28
D	48	55	58	63	63	73	73	102
E	48	48	48	63	48	48	48	63
F	M10x50L	M10x50L	M10x50L	M12x65L	M10x50L	M10x50L	M10x50L	M12x65L

下壓虎口 (Hardened / 熱處理 HRC55°~58°)  
DJ-100,130,160,200

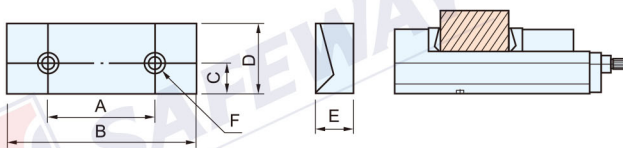

	07888042	07888044	07888046	07888048
DJ	100	130	160	200
A	60	90	90	120
B	100	130	160	200
C	22	25	25	28
D	48	55	58	65
E	32	32	32	32
F	M10x20L	M10x20L	M12x20L	M12x25L

V型虎口 (Hardened / 熱處理 HRC55°~58°)(小徑用)  
CJ-100,130,160,200,250

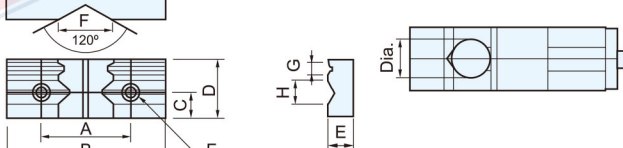

	07888050	07888052	07888054	07888056	07888058
CJ	100	130	160	200	250
A	60	90	90	120	160
B	100	130	160	200	250
C	22	25	25	28	35
D	48	55	58	63	80
E	24	24	30	36	36
F	55	55	55	70	70
G	12	12	12	12	12
H	25	25	25	30	30
L	M10x16L	M10x16L	M10x16L	M12x16L	M12x16L
Dia.	20-100	20-100	20-100	25-140	25-140

V型虎口 (Hardened / 熱處理 HRC55°~58°)(大徑用)  
CJ-1005,1305,1605,2005,2006

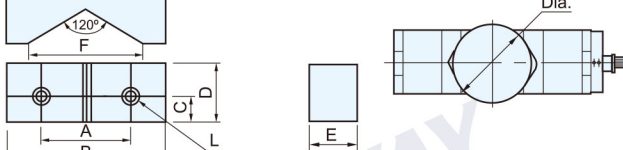

	07888240	07888242	07888244	07888246	07888248
CJ	1005	1305	1605	2005	2006
A	60	90	90	120	120
B	100	130	160	200	200
C	22	25	25	28	28
D	48	55	58	63	63
E	42	48	48	48	63
F	94	120	120	120	184
G					
H					
L	M10x16L	M10x16L	M10x16L	M12x16L	M12x16L
Dia.	100-180	100-230	100-230	110-220	220-340

大開口虎口 (Hardened / 熱處理 HRC55°~58°)  
LJ-100S,130S,160S,200S(不定寸規格)  
LJ-100V,130V,160V,200V(定寸規格)(E= $\begin{smallmatrix} 0 \\ -0.02 \end{smallmatrix}$ )

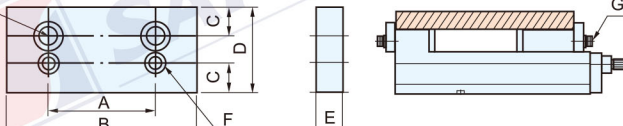

	07888060	07888064	07888068	07888072
LJ	100	130	160	200
A	60	90	90	120
B	100	130	160	200
C	22	25	25	28
D	63	69	73	88
E	21	23	23	30
F	M10x25L	M10x30L	M10x30L	M12x35L
G	M12x20L	M12x20L	M14x30L	M16x35L



**SPECIAL APPLICATION JAW PLATES**  
特殊虎口

Unit:mm

階梯虎口 (Hardened / 熱處理 HRC55°~58°)  
SJ-100S,130S,160S,200S,250S (不定規格)  
SJ-100V,130V,160V,200V,250V (定寸規格) (E,L,G=  $0_{-0.02}$ )

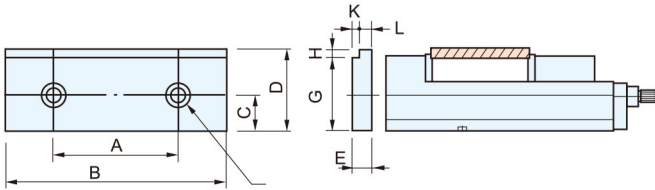

	07888076	07888080	07888084	07888088	07888090
SJ	100	130	160	200	250
A	60	90	90	120	160
B	100	130	160	200	250
C	22	25	25	28	35
D	48	55	58	63	80
E	15	15	15	18	21
F	M10x20L	M10x20L	M10x20L	M12x25L	M12x25L
G	43	50	53	58	75
H	5	5	5	5	10
K	5	5	5	5	5
L	10	10	10	13	18

SOFT JAW / 軟質虎口 (Without Hardened & Ground / 無熱處理, 無研磨)  
FJ-1001,1002,1003 FJ-1301,1302,1303 FJ-1601,1602,1603 FJ-2001,2002,2003

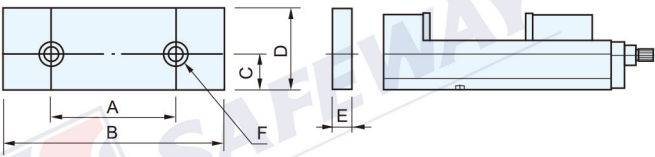

	FJ	A	B	C	D	E	F
07888092	1001	60	100	22	48	15	M10x20L
07888094	1002	60	100	22	63	21	M10x25L
07888096	1003	60	100	22	73	23	M10x30L
07888098	1301	90	130	25	55	15	M10x20L
07888100	1302	90	130	25	73	23	M10x25L
07888102	1303	90	130	25	103	30	M10x35L
07888104	1601	90	160	25	58	15	M10x20L
07888106	1602	90	160	25	73	23	M10x25L
07888108	1603	90	160	25	103	30	M10x35L
07888110	2001	120	200	28	63	18	M12x25L
07888112	2002	120	200	28	103	30	M12x35L
07888114	2003	120	200	28	123	36	M12x45L

SOFT JAW / 加厚軟質虎口 (Without Hardened & Ground / 無熱處理, 無研磨)  
FJ-1004,1005 FJ-1304,1305 FJ-1604,1605 FJ-2004,2005

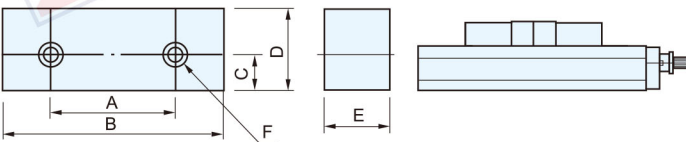

	FJ	A	B	C	D	E	F
07888116	1004	60	100	22	48	48	M10x20L
07888118	1005	60	100	22	63	48	M10x20L
07888120	1304	90	130	25	63	48	M10x20L
07888122	1305	90	130	25	73	48	M10x20L
07888124	1604	90	160	25	63	48	M10x20L
07888126	1605	90	160	25	73	48	M10x20L
07888128	2004	120	200	28	63	63	M12x25L
07888130	2005	120	200	28	102	63	M12x25L

DOUBLE V JAW / 雙V虎口 (Hardened / HRC55°~58°)  
VJ-100,130,160,200

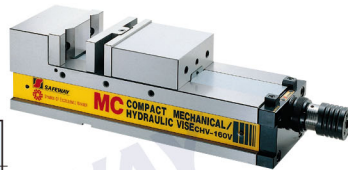
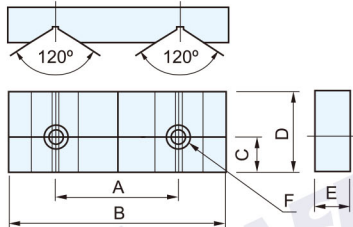

PATENTED / 專利在案

1 pc double v jaw+1 set balance jaw plates, it can be do 2 different size parts  
一只雙V虎口加一組翹翹板虎口, 可做兩只大小不一圓棒型工件

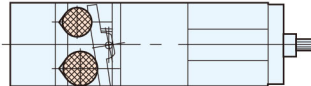

1 pc flat jaw plate+1set balance jaw plates, it can be do 2 different clearance parts  
一只平面虎口加一組翹翹板虎口, 可做兩只大小不一工件

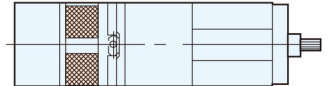

2 Sets balance jaw plates (hardened) it can be do angle part  
兩組翹翹板虎口(硬質虎口), 可做一只單斜度或雙斜度工件

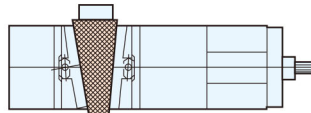

2 Set balance jaw plates (soft)  
It can be do 2 irregular parts  
兩組翹翹板虎口(軟質虎口), 可做兩只不規則形狀工件(不規則形狀自行雕刻成形)

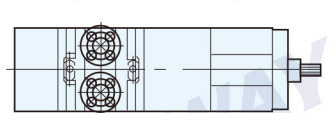

BALANCE JAW / 翹翹板虎口 (Hardened / 熱處理 HRC55°~58°)  
TJ-100,130,160,200

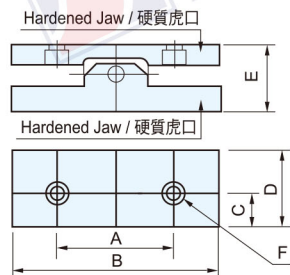

BALANCE JAW / 翹翹板虎口 (Soft Jaw Plate / 軟質虎口)  
TJ-100F,130F,160F,200F

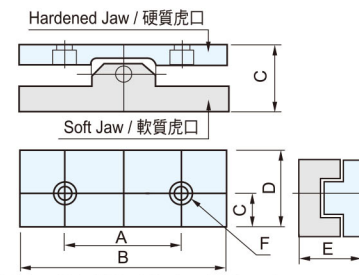

Soft Jaw Plate Without Hardened & Ground  
軟質虎口無熱處理, 無研磨

		A	B	C	D	E	F	REMARK
07888200	VJ-100	60	100	22	48	24	M10x20L	ø10-65mm
07888202	VJ-130	90	130	25	55	24	M10x20L	ø10-65mm
07888204	VJ-160	90	160	25	58	24	M10x20L	ø10-65mm
07888206	VJ-200	120	200	28	63	30	M12x25L	ø25-85mm
07888210	TJ-100	60	100	22	48	48	M10x20L	18°
07888212	TJ-130	90	130	25	55	55	M10x20L	13°
07888214	TJ-160	90	160	25	58	58	M10x20L	11°
07888216	TJ-200	120	200	28	63	63	M12x25L	9°
07888220	TJ-100F	60	100	22	48	48	M10x25L	18°
07888222	TJ-130F	90	130	25	55	55	M10x20L	13°
07888224	TJ-160F	90	160	25	58	58	M10x20L	11°
07888226	TJ-200F	120	200	28	63	63	M12x25L	9°

STEP GUIDE KEY / 階梯鍵 (Hardened / 熱處理 HRC55°~58°)  
全部精密研磨

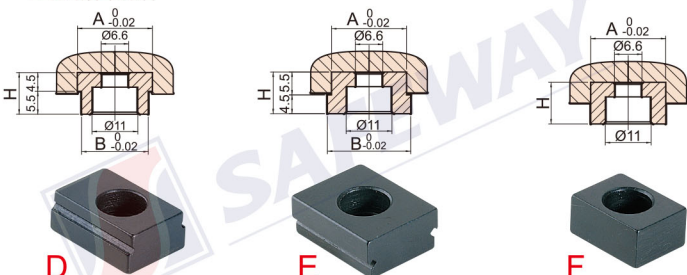

		A	B	H	L	
D	07901612	KA16x12	16	12	10	25
	07901614	KA16x14	16	14	10	25
	07901618	KA16x18	16	18	10	25
E	07901620	KA16x20	16	20	10	25
	07901622	KA16x22	16	22	10	25
	07901812	KA18x12	18	12	10	25
D	07901814	KA18x14	18	14	10	25
	07901816	KA18x16	18	16	10	25
	07901820	KA18x20	18	20	10	25
E	07901822	KA18x22	18	22	10	25
	07901212	KA12x12	12		8	22
	07901414	KA14x14	14		10	22
F	07901616	KA16x16	16		10	22
	07901818	KA18x18	18		10	22
	07902020	KA20x20	20		10	22
	07902222	KA22x22	22		12	25



**STATIONARY JAW / MOVABLE JAW / STEP JAW**

特殊口金

Hardened Jaw (HRC55°)  
鋼製硬爪，研磨 (HRC55°)

Soft Jaw (Without ground)  
鋼製軟爪，不研磨

Aluminum Jaw (Without ground)  
鋁合金，不研磨

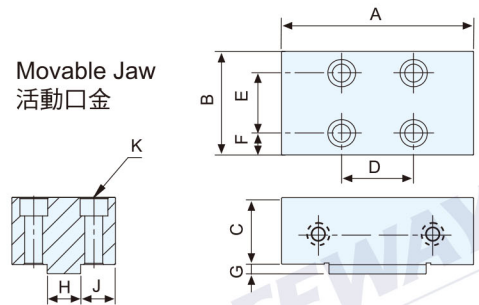
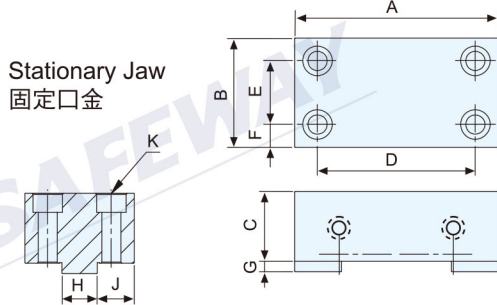
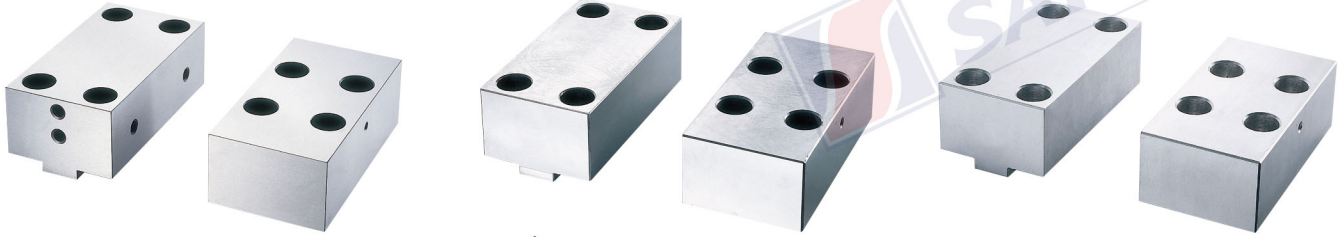

Hardened Jaw HRC55° Ground 鋼製硬爪，研磨HRC55°		Soft Jaw Without Ground 鋼製軟爪，不研磨	
Order NO. 訂購編號	Model 型號	Order NO. 訂購編號	Model 型號
10900100	MA-100A	10902100	MA-100B
10900130	MA-130A	10902130	MA-130B
10900160	MA-160A	10902160	MA-160B
10900200	MA-200A	10902200	MA-200B
10900250	MA-250A	10902250	MA-250B

Unit: mm, kg

		A	B	C	D	E	F	G	H	J	K	N.W. 淨重	Remark 備註
Stationary Jaw 固定口金	10900100	100	78	45	74	44	19.5	7	18	32.5	M10x50L	3.0	
	10900130	130	83	52	95	45	21.5	8	24	32	M12x55L	4.0	
	10900160	160	86	55	124	50	18	8	28	29	M14x60L	6.0	
	10900200	200	100	60	150	62	19	9.5	28	36	M16x65L	9.0	
	10900250	250	124	78	200	75	24.5	9.5	30	47	M20x90L	17.6	
Movable Jaw 活動口金	10910100	100	64	45	37	35	14.5	7.5	18	23	M10x50L	2.5	
	10910130	130	74	52	45	42	16	8.5	24	25	M12x55L	4.5	
	10910160	160	86	55	60	50	18	8.5	28	29	M14x60L	6.0	
	10910200	200	97	60	74	59	19	9.5	28	34.5	M16x70L	9.0	
	10910250	250	124	78	92	75	24.5	9.5	30	47	M20x90L	17.6	

Step Jaw (Stationary Jaw)  
階梯口金 (固定)

Step Jaw (Movable Jaw)  
階梯口金 (活動)

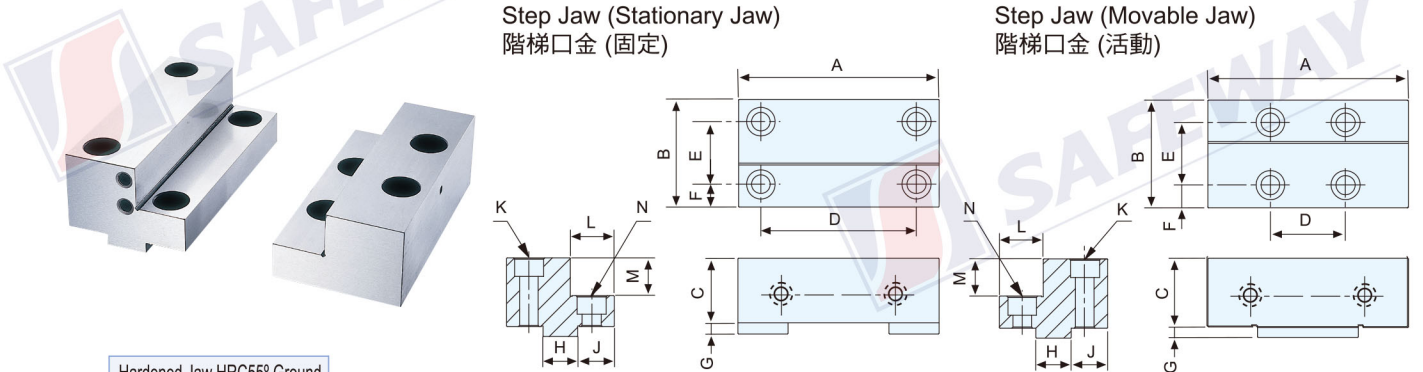

Hardened Jaw HRC55° Ground  
鋼製硬爪，研磨HRC55°

Unit: mm, kg

		A	B	C	D	E	F	G	H	J	K	L	M	N	N.W. 淨重	Remark 備註
Stationary Jaw 固定口金	10920100	100	78	45	74	44	19.5	7	18	32.5	M10x50L	32.5	25	M10x25L	2.0	
	10920130	130	83	52	95	45	21.5	8	24	32	M12x55L	35	30	M12x25L	3.0	
	10920160	160	86	55	124	50	18	8	28	29	M14x60L	35	30	M14x30L	4.2	
	10920200	200	100	60	150	62	19	9.5	28	36	M16x70L	38	30	M16x35L	7.0	
	10920250	250	124	78	200	75	24.5	9.5	30	47	M20x90L	50	40	M20x50L	14	
Movable Jaw 活動口金	10930100	100	64	45	37	35	14.5	7.5	18	23	M10x50L	26	25	M10x25L	1.5	
	10930130	130	74	52	45	42	16	8.5	24	25	M12x55L	30	30	M12x25L	2.8	
	10930160	160	86	55	60	50	18	8.5	28	29	M14x60L	35	30	M14x30L	4.2	
	10930200	200	97	60	74	59	19	9.5	28	34.5	M16x70L	38	30	M16x35L	7.0	
	10930250	250	124	78	92	75	24.5	9.5	30	47	M20x90L	50	40	M20x50L	14	